

NO	REVISION	BY	DATE
A	FIRST ISSUE	KMG	04/12/09
B	LOTS DP 392856 ADDED	KMG	15/12/09
C	AERIAL PHOTO REMOVED	KMG	09/02/10

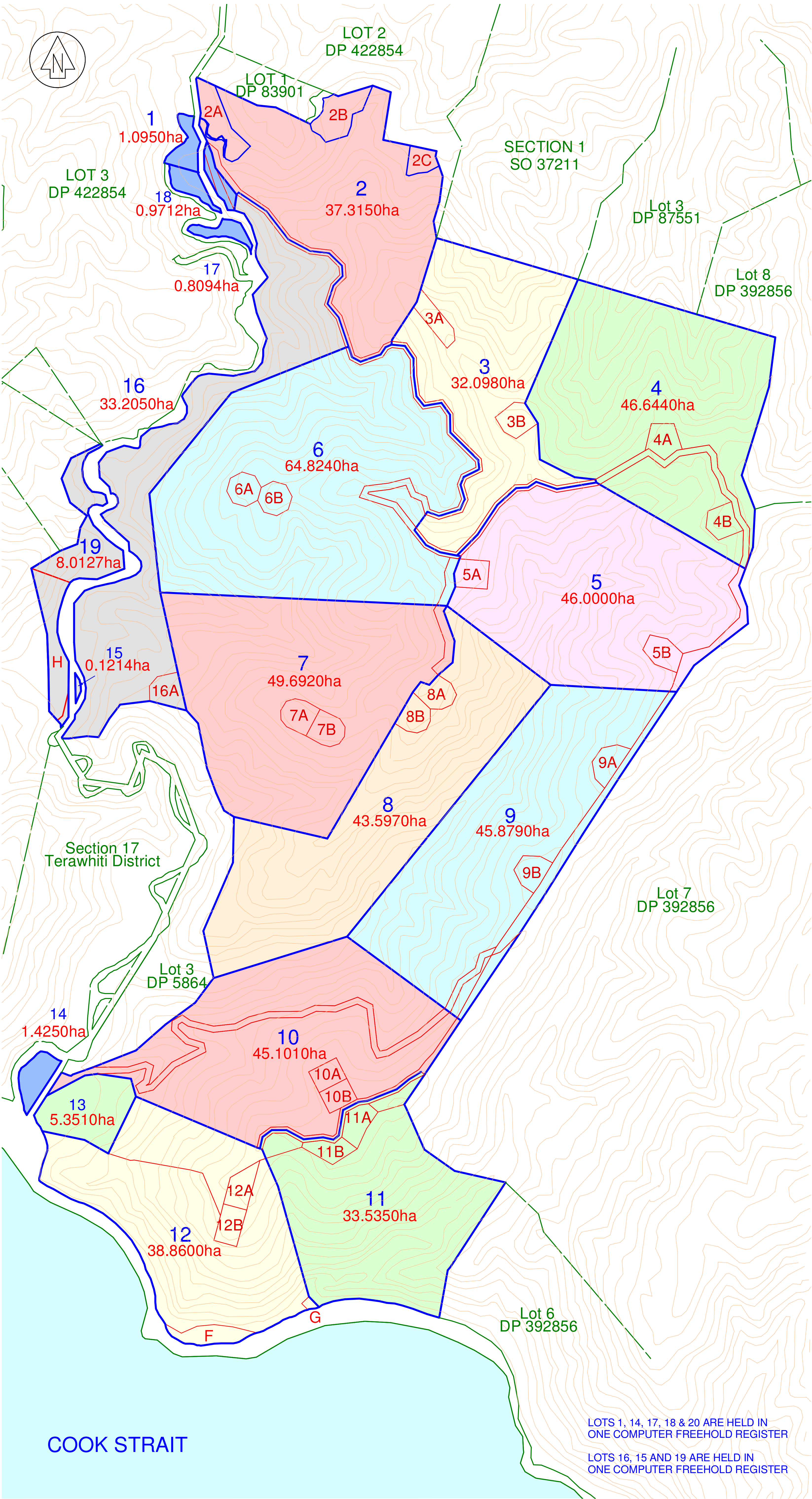
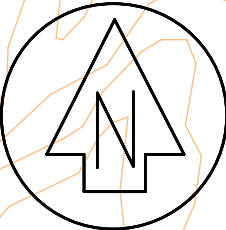

COOK STRAIT

LOTS 1, 14, 17, 18 & 20 ARE HELD IN
ONE COMPUTER FREEHOLD REGISTER

LOTS 16, 15 AND 19 ARE HELD IN
ONE COMPUTER FREEHOLD REGISTER



Level 6 - 8 Willis Street
PO Box 583 Wellington New Zealand
Phone (04) 472-2261 Fax (04) 471-2372
Email survey@spencerholmes.co.nz

CLIENT
NEW ZEALAND FORESTRY GROUP

PROJECT
KINNOULL STATION SOUTH MAKARA

DRAWING TITLE
SUBDIVISION LAYOUT

DESIGN CONSULTANT

Copyright of this drawing is vested in Spencer Holmes Ltd.
The Contractor shall verify all dimensions on site.

CAUTION - The information shown on this plan has been prepared under specific instruction from the client and is intended solely for the clients use. The information is valid as at the date of survey. Spencer Holmes Limited will accept no liability for any consequence arising out of the use of this plan, or the information thereon whether in hard copy or electronic format by any other party for any purpose whatsoever.

☐ CAD FILE 070499 Sig 2 LT - SP4
☐ DRAWN KMG
☐ CHECKED HLM

☐ FB
☐ DATE 09/02/10

SCALE
1 : 6000

DRAWING NUMBER
S07-0499-SP4

REV
A1

REV
C

RESOURCE MANAGEMENT - LAND PLANNING - SURVEYING - STRUCTURAL - CIVIL - FIRE